

## Headlamp washer hoses

### To remove

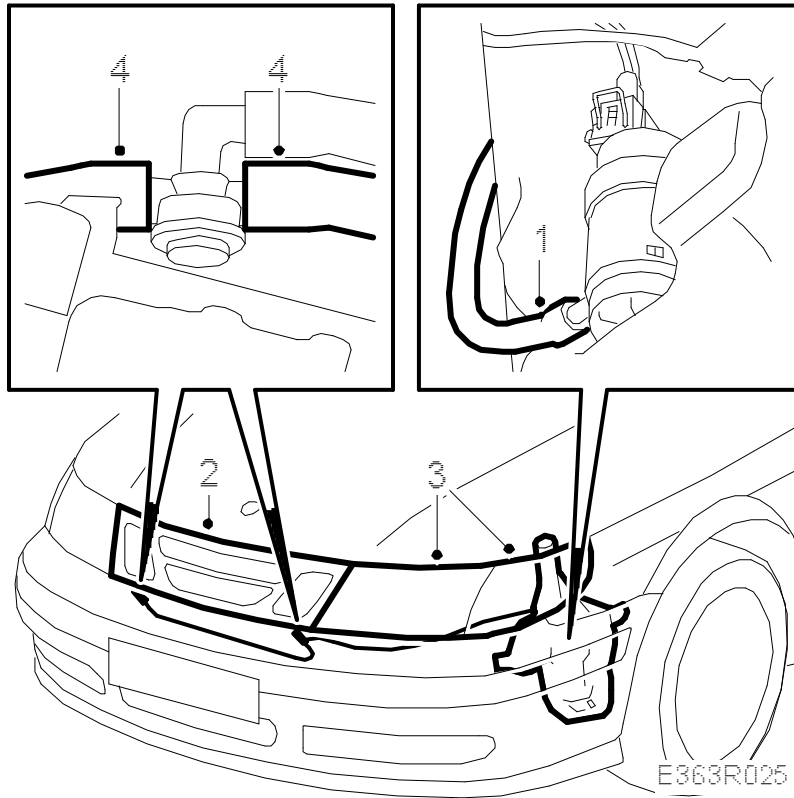

1. Disconnect the hose from the washer pump.
2. Remove the grille.
3. Remove the direction indicator and headlamp, refer to [Headlamps](#).
4. Remove the washer hose from the check valve and the washer nozzles.

### To fit

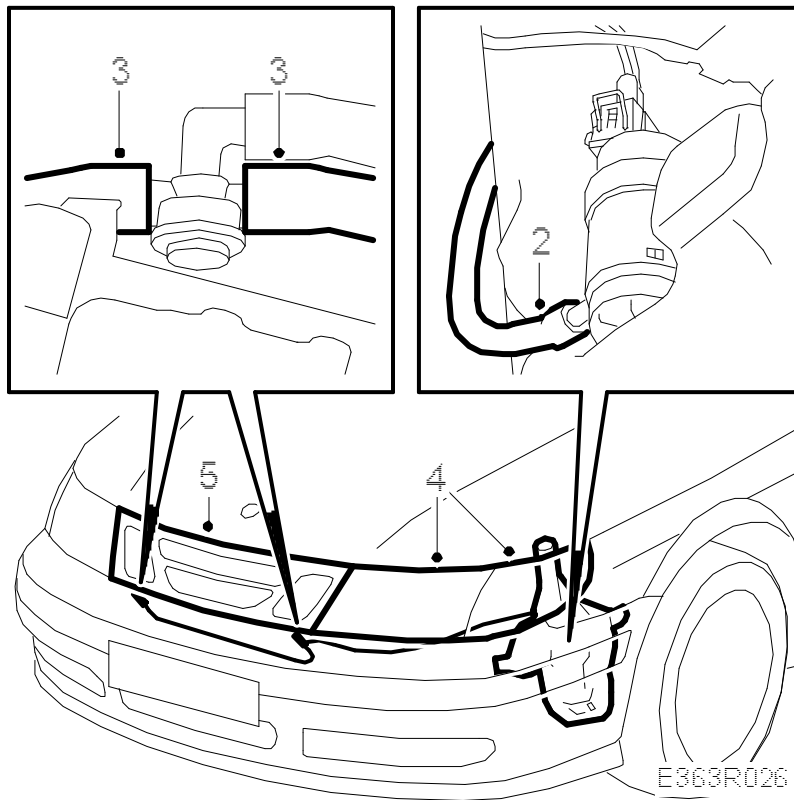

1. Fit the hose in its original position.
2. Attach the hose to the washer pump.
3. Connect the hose to the washer nozzles and check valve.
4. Fit the direction indicator and headlamp, refer to [Headlamps](#).
5. Fit the grille.