

Washer fluid reservoir

To remove

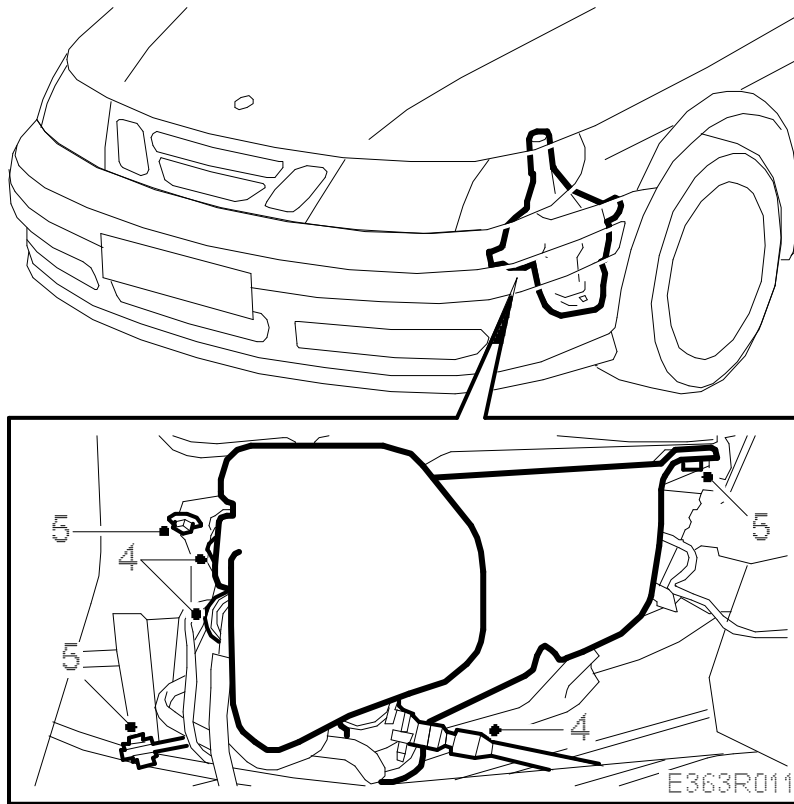

1. Drain the washer fluid from the reservoir.
2. Raise the car.
3. Remove the two retaining screws on the front of the wing liner.
4. Pull out the two pumps and the level sensor from the reservoir and let them hang by their hoses and leads.
5. Remove the 3 reservoir retaining screws and pull the washer fluid reservoir straight down.

To fit

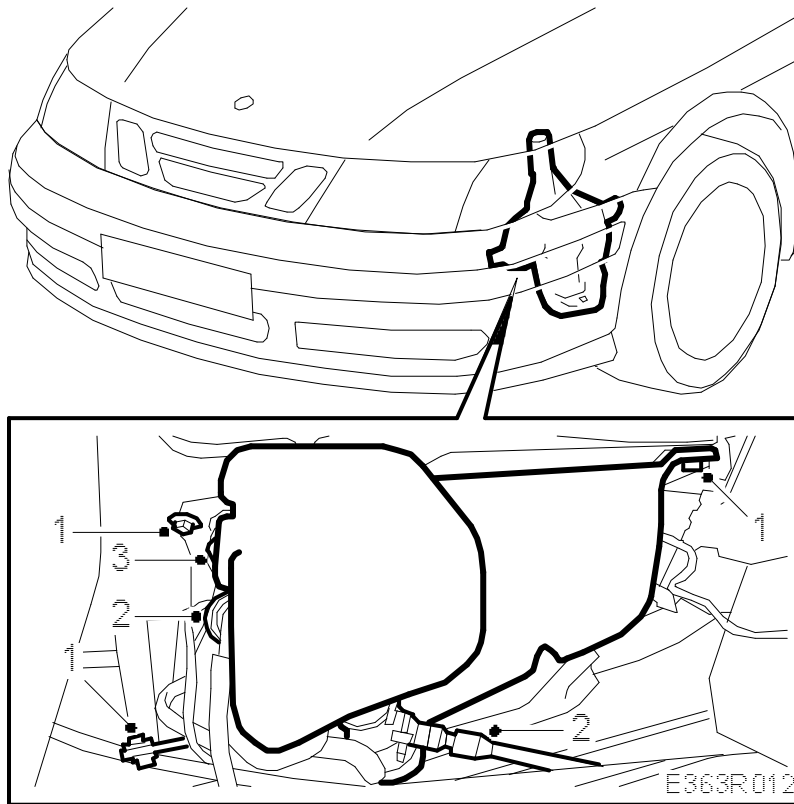

1. Place the reservoir in its correct position and fit the retaining screws.
2. Fit the pumps.
3. Fit the level sensor with its float pointing downwards.
4. Fit the wing liner with the two retaining screws.
5. Lower the car.
6. Fill the reservoir with washer fluid.