

Adjusting the handbrake shoes

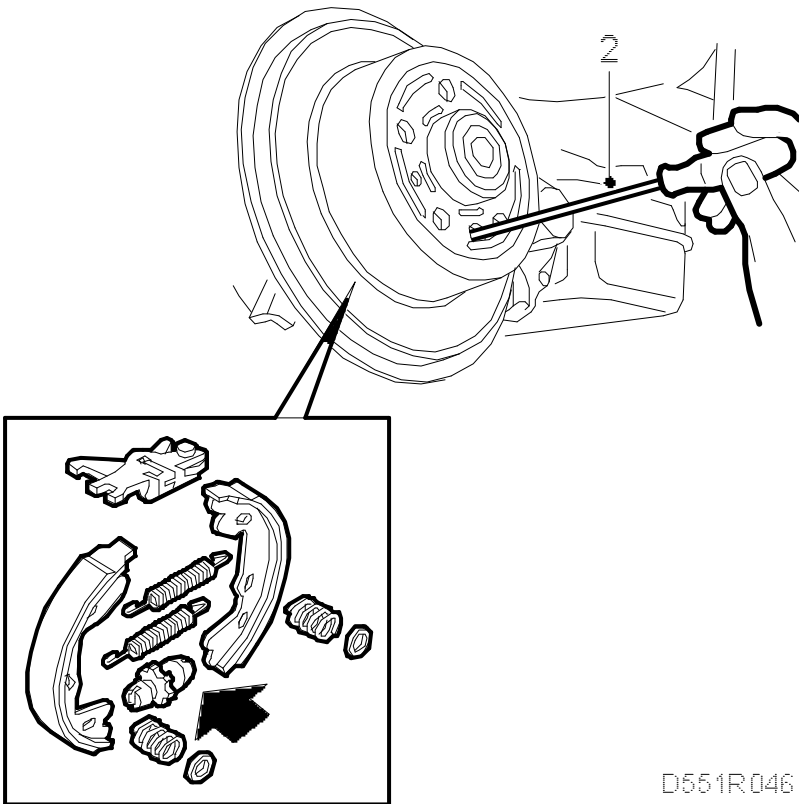

D551R046

1. Release the handbrake.
2. Raise the car and remove the rear wheels.
3. Check that the cable does not act on the lever. If it does, press the cable holder out of the bracket.
4. Screw out the adjustment with a screwdriver until the brake disc is locked.
5. Then screw back the adjustment until the brake disc rotates freely.
6. Repeat the same procedure on the other rear wheel.
7. Fit the rear wheels, see [Wheels](#).
8. Apply the handbrake 3-6 notches and check that both rear wheels are locked. If required, adjust the cable adjuster, see [Adjustment of the cable adjuster](#).

The handbrake shoes must be replaced when more than 10 threads are visible on the adjusting unit.

9. Lower the car to the floor.