

## Main components

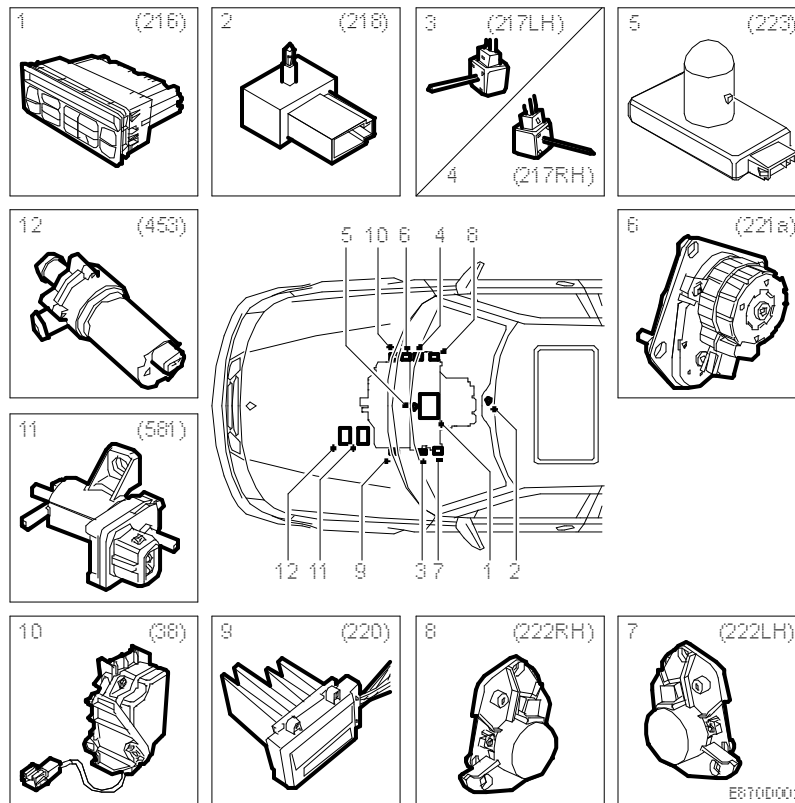

1. Control module, ACC unit (216)
2. Cabin temperature sensor (218)
3. Mixed-air temperature sensor, LH (217LH)
4. Mixed-air temperature sensor, RH (217RH)
5. Solar sensor (223)
6. Stepping motor, air distribution (221a)
7. Stepping motor, mixed-air, LH (222LH)
8. Stepping motor, mixed-air, RH (222RH)
9. Ventilation fan control (220)
10. Air recirculation motor (38)
11. Heat exchanger shut-off valve (581)
12. (453)

12. Circulation pump (453) (certain engine versions only)