

Radiator fan, V6**Warning**

Do not touch the fan before unplugging the fan connectors.

To remove

1. Remove the upper engine cover.

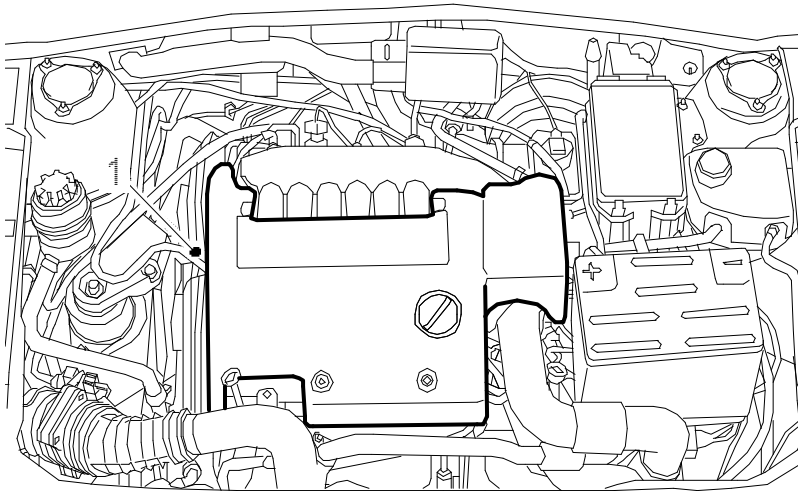

E260R095

- 2.

Remove the turbo pressure hose together with the bypass pipe and valve. Remove the vacuum hose on the turbo bypass valve.

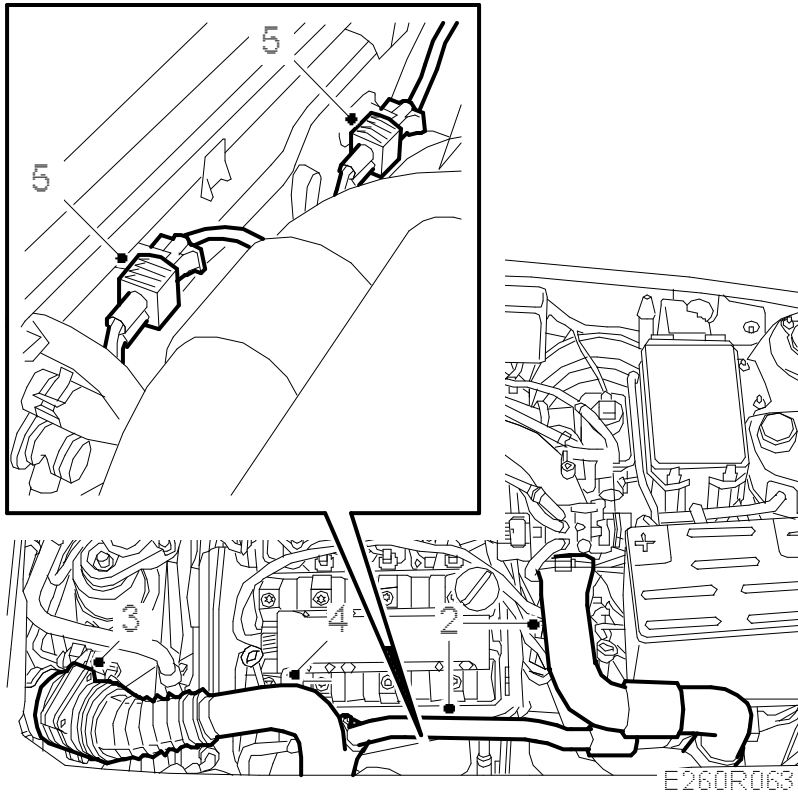
**Note**

There is an O-ring at the bypass pipe's attachment to the turbo intake pipe.

3. Remove the mass air flow sensor and hose.
4. Remove the turbo intake pipe.
5. Unplug the fan motor connectors.
- 6.

Remove the radiator fan.

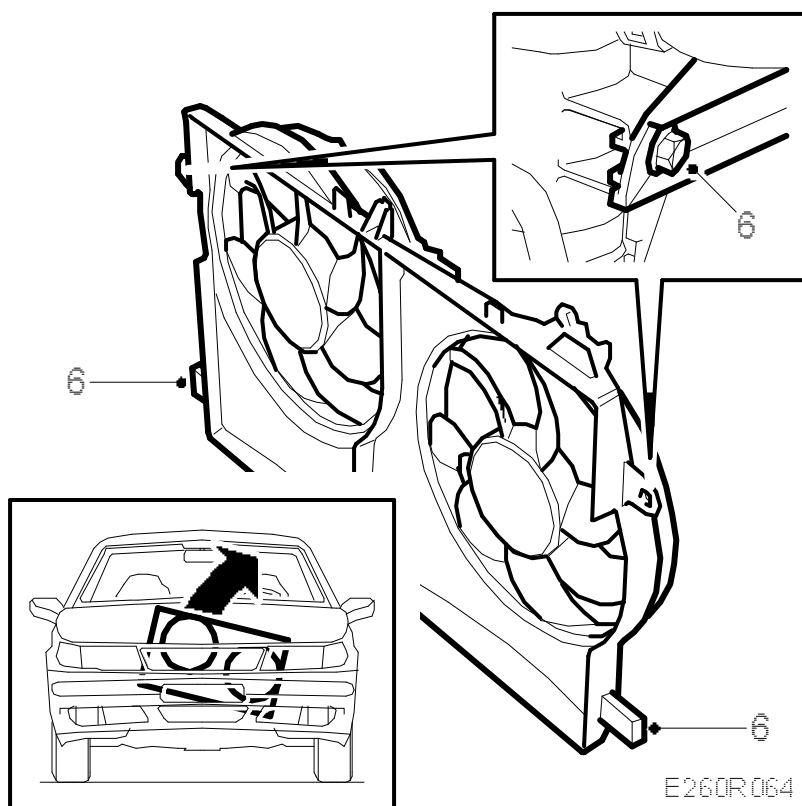

To fit

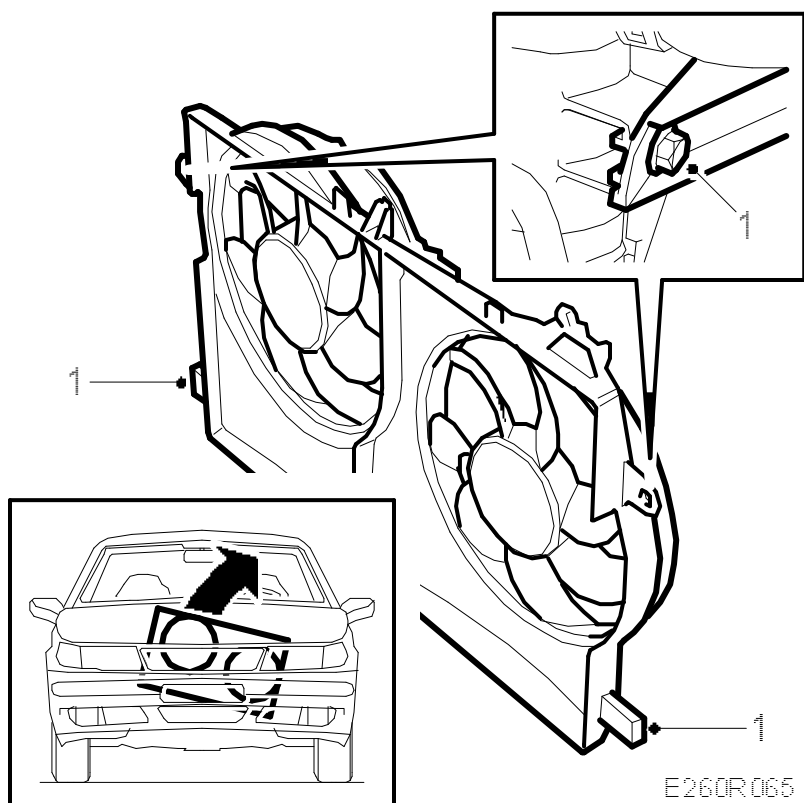

Note

Spray the connectors with Kontakt 61, part no. 30 04 520, before connecting.

1. Fit the radiator fan.

Tightening torque: 8 Nm (5.9 lbf ft)

2. Plug in the fan motor connectors.

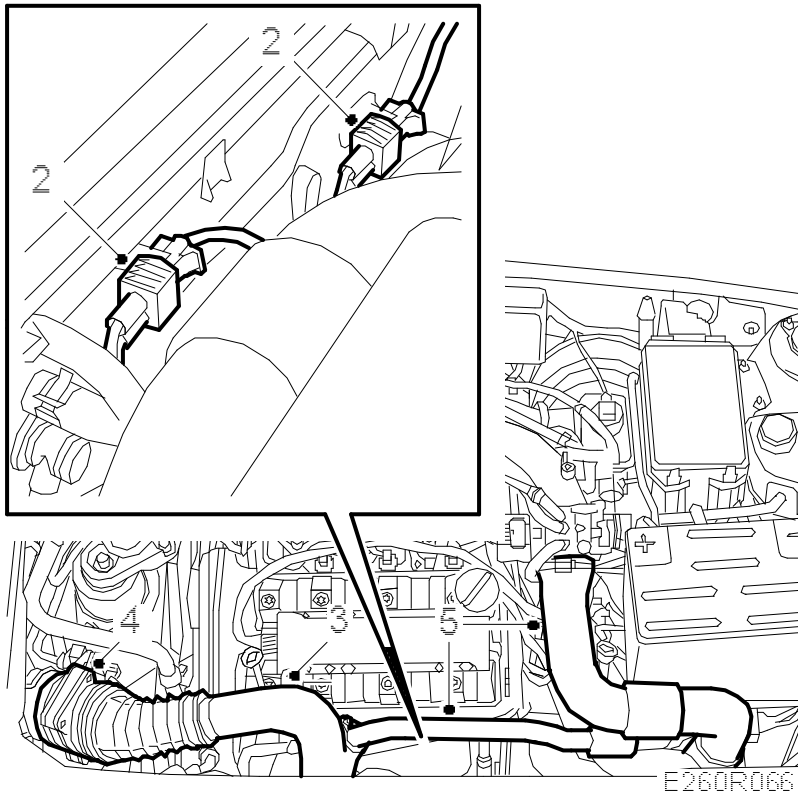

3. Fit the turbo intake pipe.

Tightening torques:

Turbo/intake pipe, V-clamp: 3 Nm (2.2 lbf ft)

Crankcase breather pipe: 24 Nm (17.7 lbf ft)

4. Fit the mass air flow sensor and hose.
5. Fit the turbo pressure hose together with bypass pipe and valve. Connect the vacuum hose to the turbo bypass valve.

Tightening torques:

Bypass pipe/intake pipe, bolt: 8 Nm (5.9 lbf ft)

Bypass pipe, hose clip: 8 Nm (5.9 lbf ft)

6. Fit the upper engine cover.

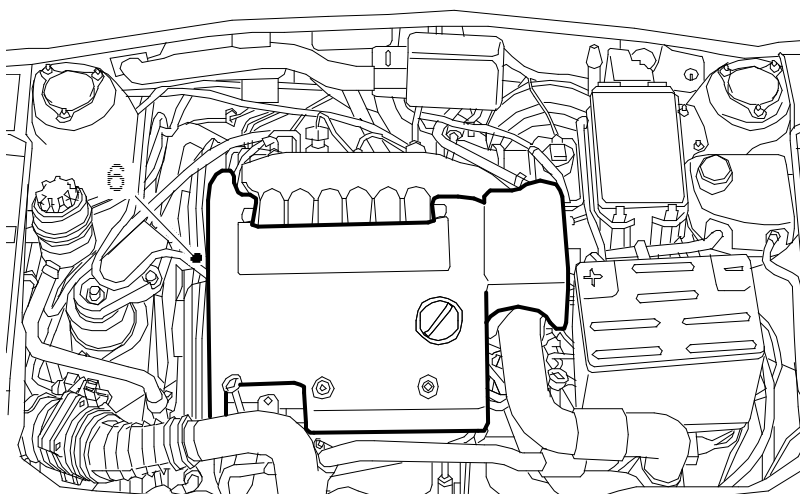

E260R096