

Headlamp wipers**Description of operation**

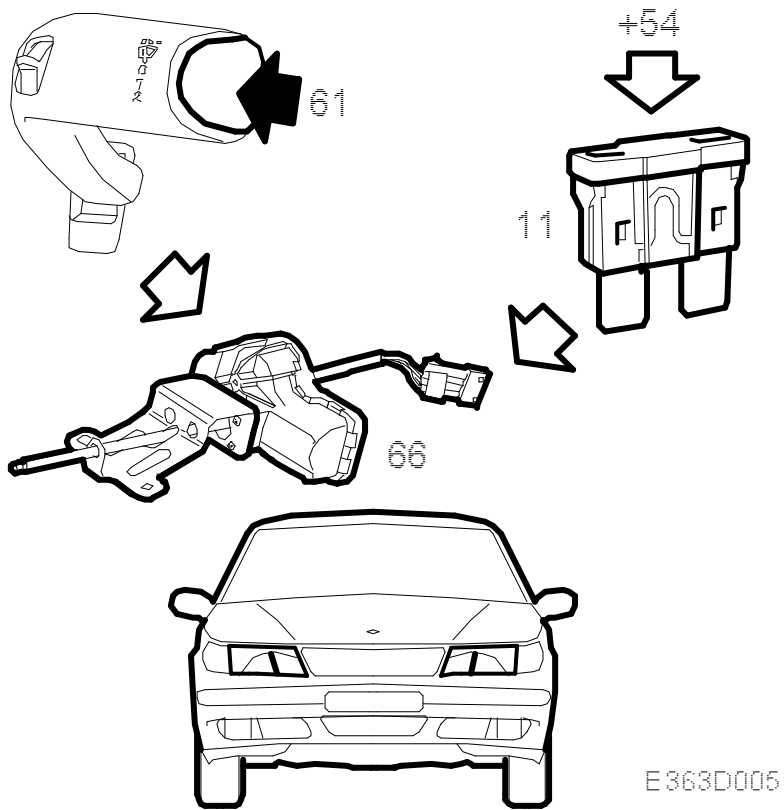
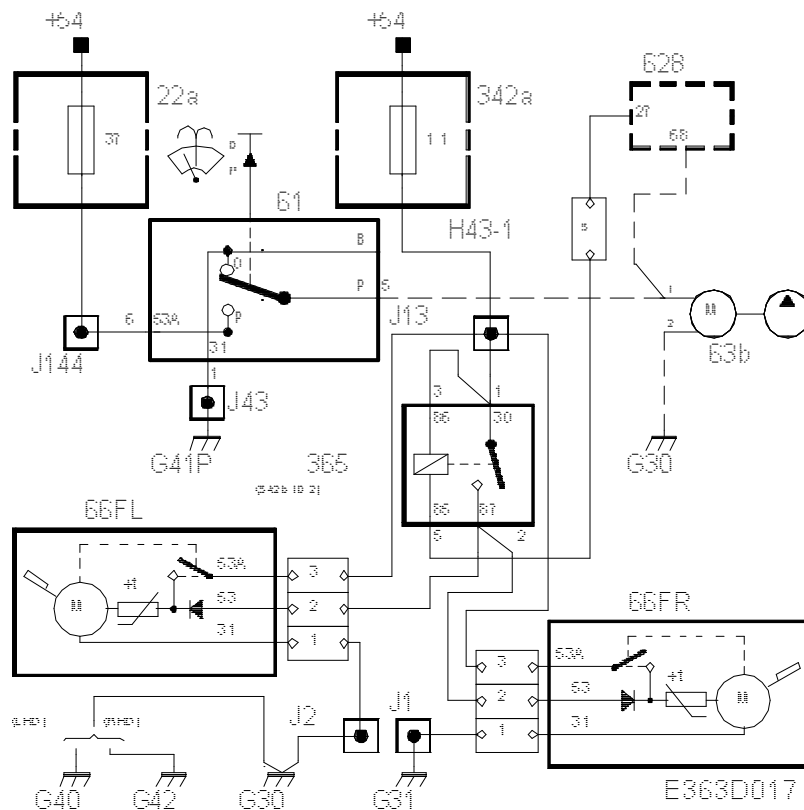

A wiper is mounted under each headlamp. They are connected to start wiping whenever the windscreen washers are activated.

When the washers are activated and the wiper motors have made 2 sweeps, the built-in limit switches in the motors brake and the wipers stop. The wiper motors only make 2 sweeps even if the washers are activated for a long time.

A diode in each motor (66FL and 66FR) prevents power from the motor feedback circuit from reaching the washer motor from the rear.

Each wiper motor incorporates overload protection in the form of a cut-out actuated by a PTC resistor. The cut-out is connected in series with the motor and trips if the load is excessive, e.g. if the wiper blades have frozen to the headlamps.

When the switch (61) is turned on, +54 current is supplied via fuse 37 from switch pin 5 to the washer pump (63a) and to DICE pin 68. The DICE (628) grounds pin 27 for about 0.5 seconds and the relay (365) closes. The motors (66FL and 66FR) are supplied with current to pin 2.