

Washer system, rear window (5D)

The rear window washer system comprises a washer pump and a button on the windscreen wiper stalk switch. The washer starts when the button on the switch is depressed (spring return).

The washer pump is a centrifugal pump that supplies washer fluid to the rear window and headlamps. The fluid fills the centre of the pump and the form of the pump shaft and the polarity of the voltage sends the fluid to the rear for the rear window wiper or forwards to the headlamps.

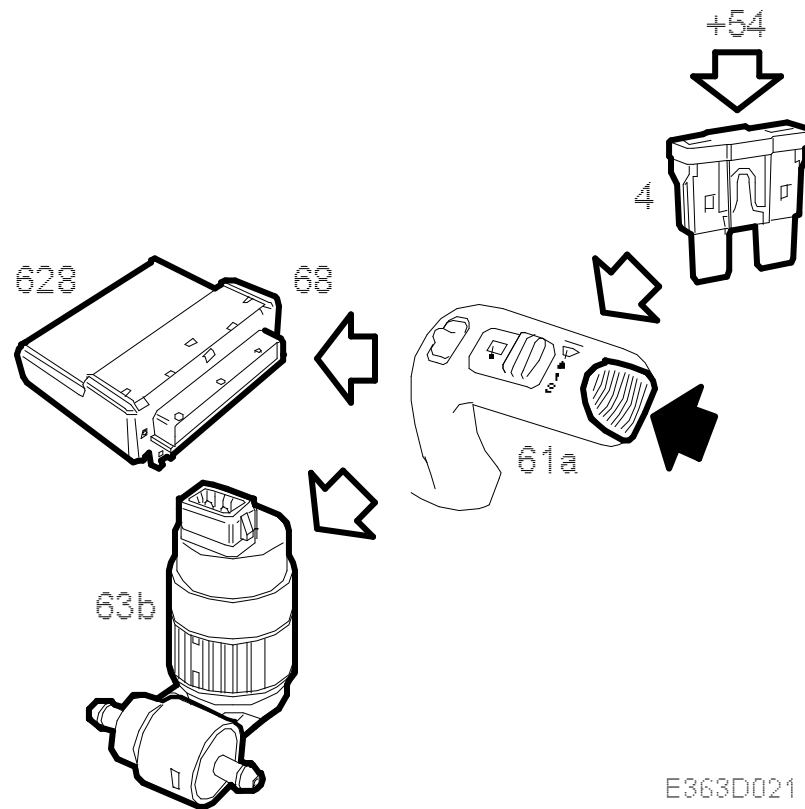

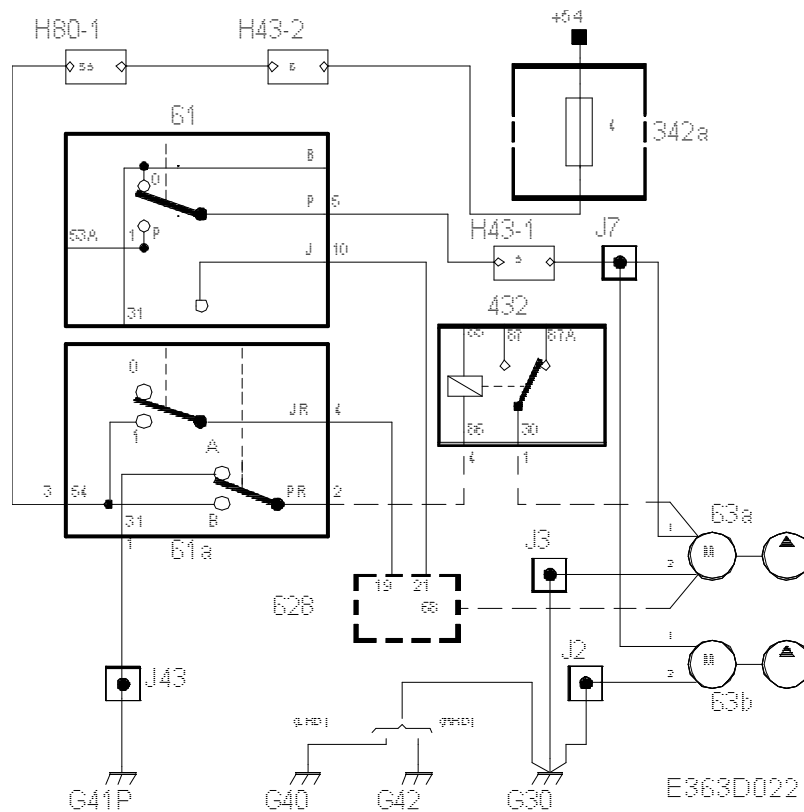

The washer pump supplies two jets with washer fluid through a hose. The jets are located by the wiper arm mounting on the wiper motor shaft and direct the fluid to selected points of the rear window on each side of the wiper blade.

There is a check valve in the washer hose that prevents it from emptying between washes.

When the washers are activated, DICE starts the rear window wiper, which continues for about 5 seconds (3 wiper strokes) after the washers have stopped.

After 8 seconds, the wipers perform an additional stroke.

If the rear window washer switch (61a) closes, the rear window washer relay (432) will be supplied with power from pin 2 on the switch (61a). Pin 19 on DICE (628) is supplied with power from pin 4 on the switch (61a). Pin 12 on DICE grounds pin 5 to activate the relay (83a) and the motor (62R) starts to wipe. The relay (83a) is grounded for 5 seconds after the switch (61a) has been depressed.