

**Anti-roll bar bush****To remove**

E 732R055

1. Remove the anti-roll bar.
- 2.

Tap out the clamp's screw.

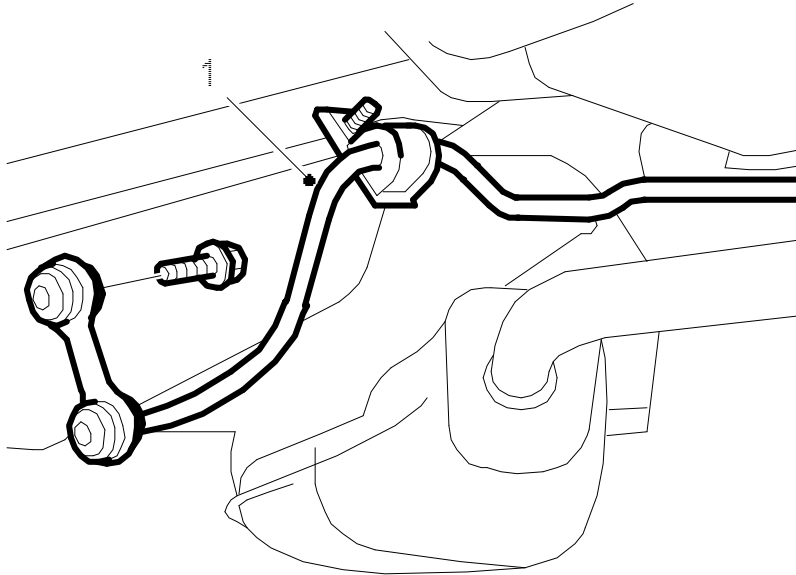
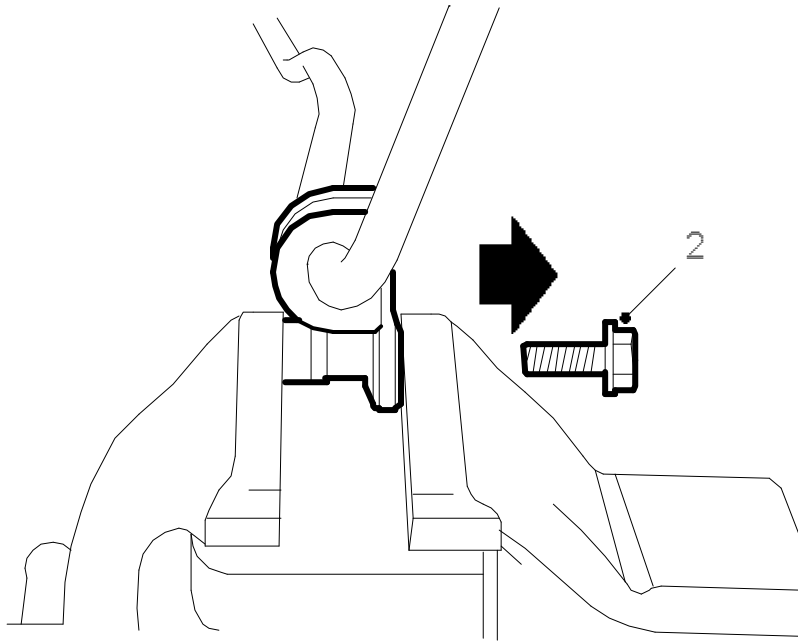

E732R056

3. Dismantle the clamp and remove the bush.

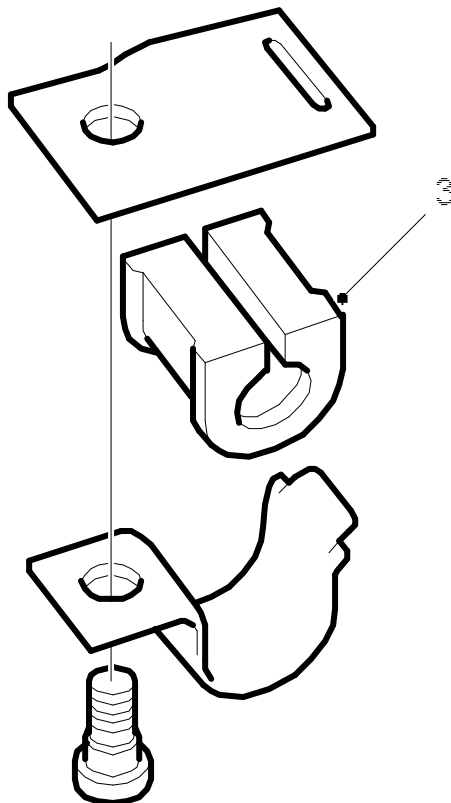

E732R057

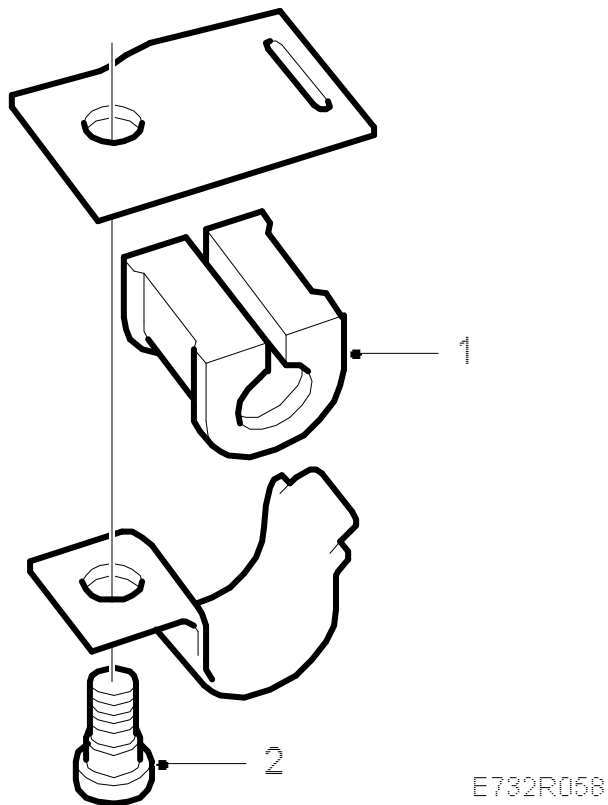
**To fit**

1. Lubricate the bush with Molycote 33, fit it in place and mount the clamp.
2. Tap in the clamp's bolt.
- 3.

Fit the anti-roll bar.

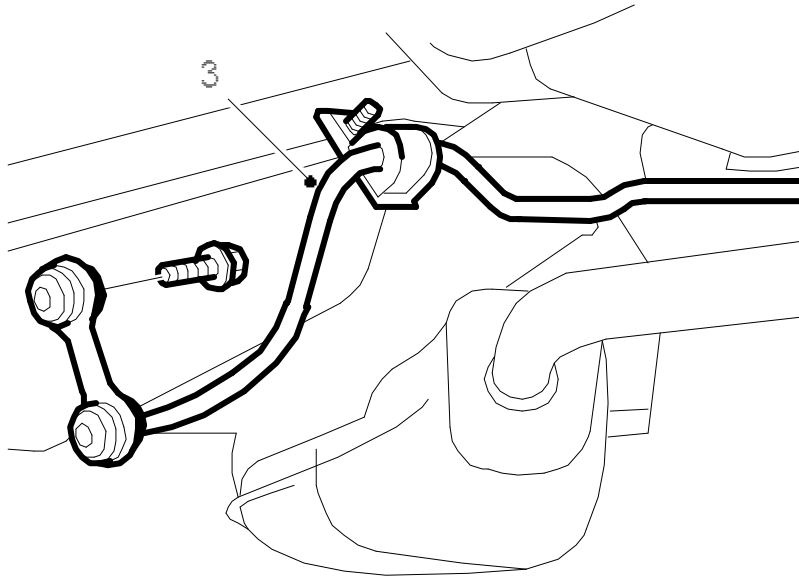

E732R059