

Crankshaft position sensor



Warning

Be very careful as the exhaust pipe from the turbo can become extremely hot.

To remove

1. Remove the manifold's heat shield.

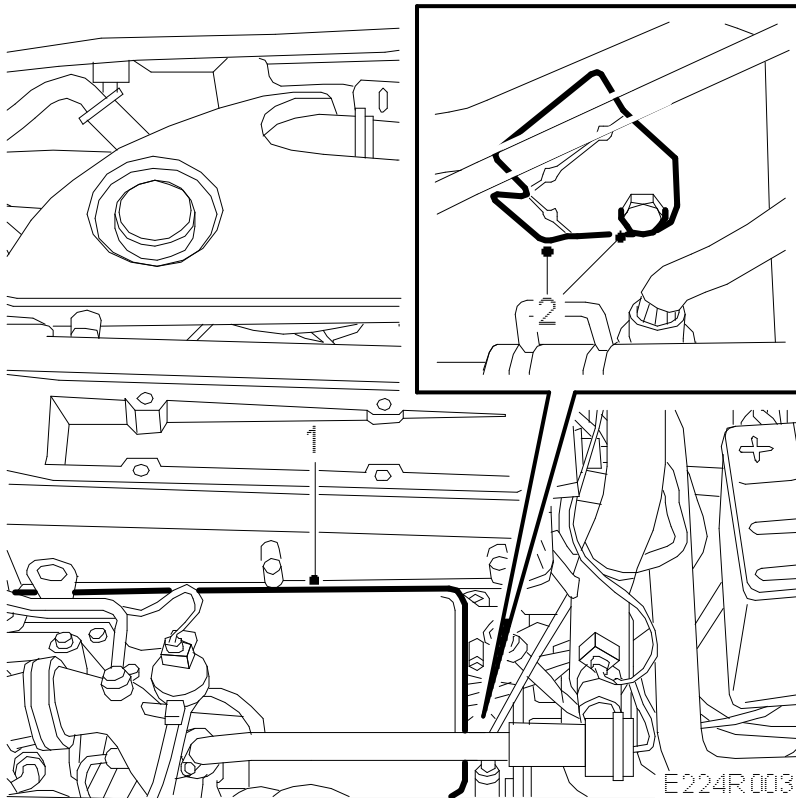

2. Undo the bolt securing the heat shield and sensor.
- 3.

Detach the sensor and O-ring.

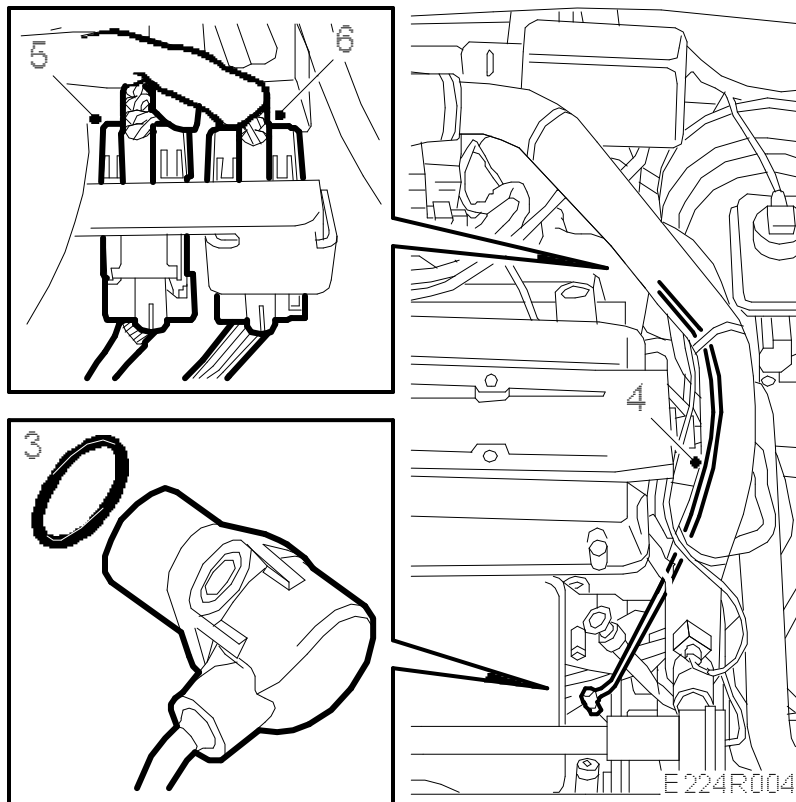

4. Follow the sensor connecting cable and undo the clip on the water pipe.
5. Detach the connector from the holder.
6. Unplug the connector.
7. Change the sensor.

To fit

- 1.

Fit the sensor provisionally so that the wiring runs alongside the water pipe. Change the O-ring if necessary and lubricate it with engine oil.

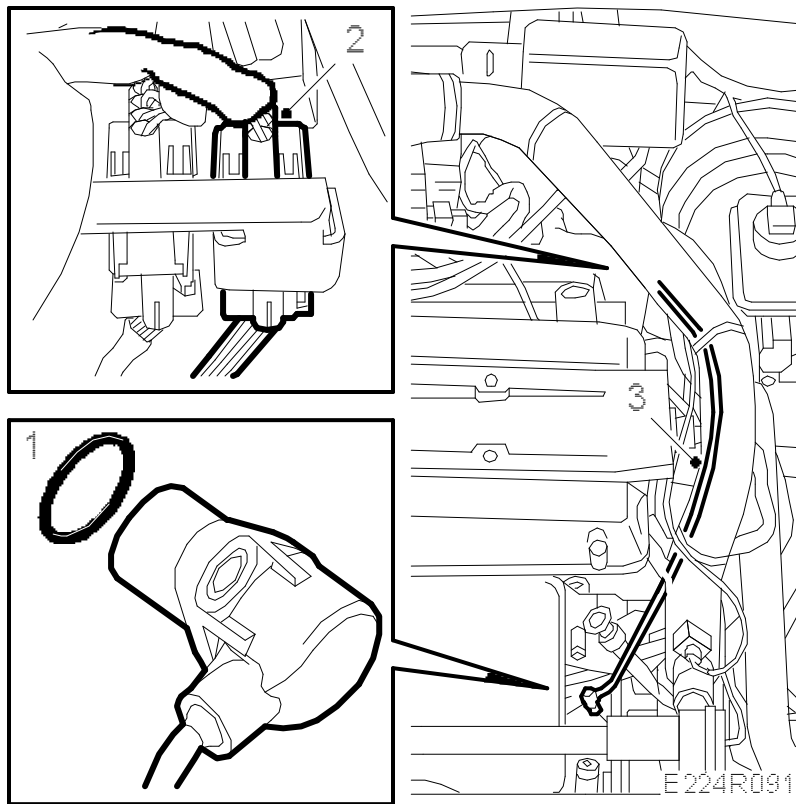

2. Spray the connector with Kontakt 61 contact cleaner (part no. 30 21 763), press the halves together and fit the connector in the holder.
3. Secure the wiring with the retaining clip. Take care to ensure that the wiring is not pinched or damaged by the clip.
- 4.

Press in the sensor and screw it on with the O-ring fitted together with the heat shield. Make sure the O-ring is positioned correctly so that the sensor bottoms in the engine block. Otherwise, there is a risk of the sensor mounting lug breaking off.

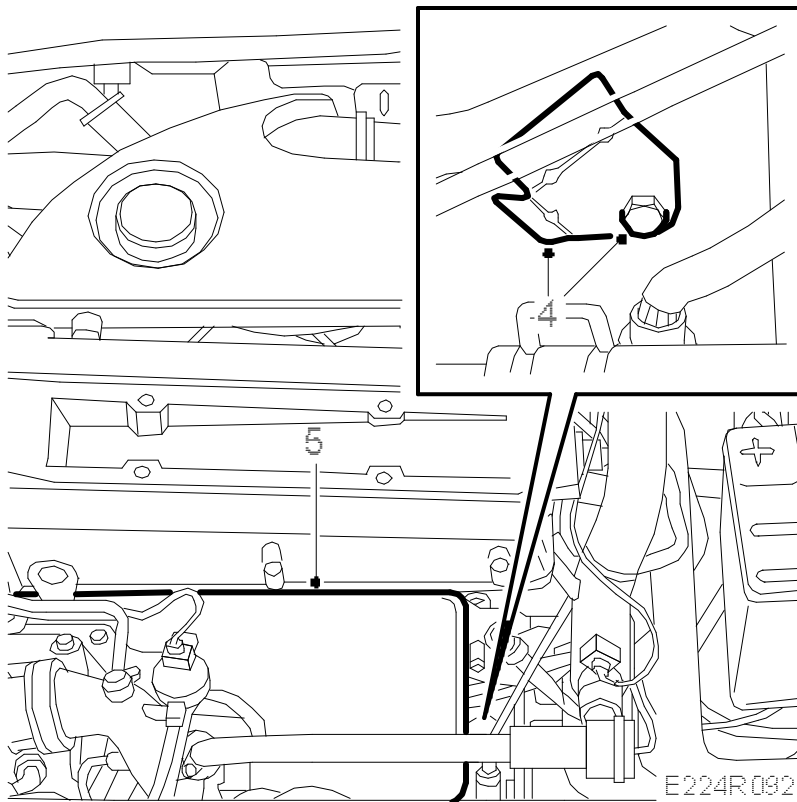

5. Apply Molykote 1000 (part No. 30 20 271) or the equivalent to the manifold heat shield's retaining bolt and fit the heat shield in place.
6. Start the engine and check for oil leaks.

Tightening torque 50 Nm (36 lbf ft)